

690 Pairs Distribution Frame

CNSNE-2017

SPECIFICATION

The Distribution Frame is a single vertical, modular distribution frame offering ease of transport and flexibility of installation.

- Material: Distribution Frame used is 1.5mm cold rolled-steel, Gray powder coating.
- Capacity: 690 Pairs(using 10 pairs module)
- Weight: about 10 Kg
- Earthing Kit: 2.5mm² Stranded bare Copper
Length: 40cm

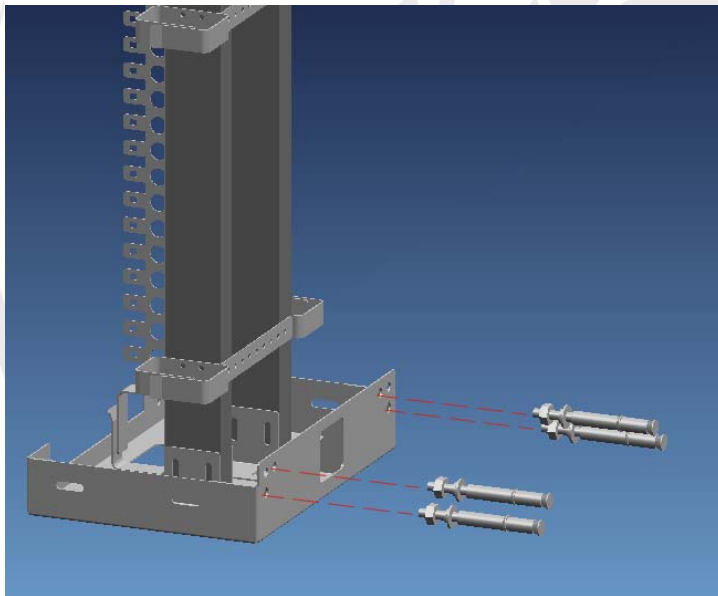

Distribution Frame is fixed with the Screws in the wall.

Dimensions	Height×Width×Depth
	1770×297×210(mm)

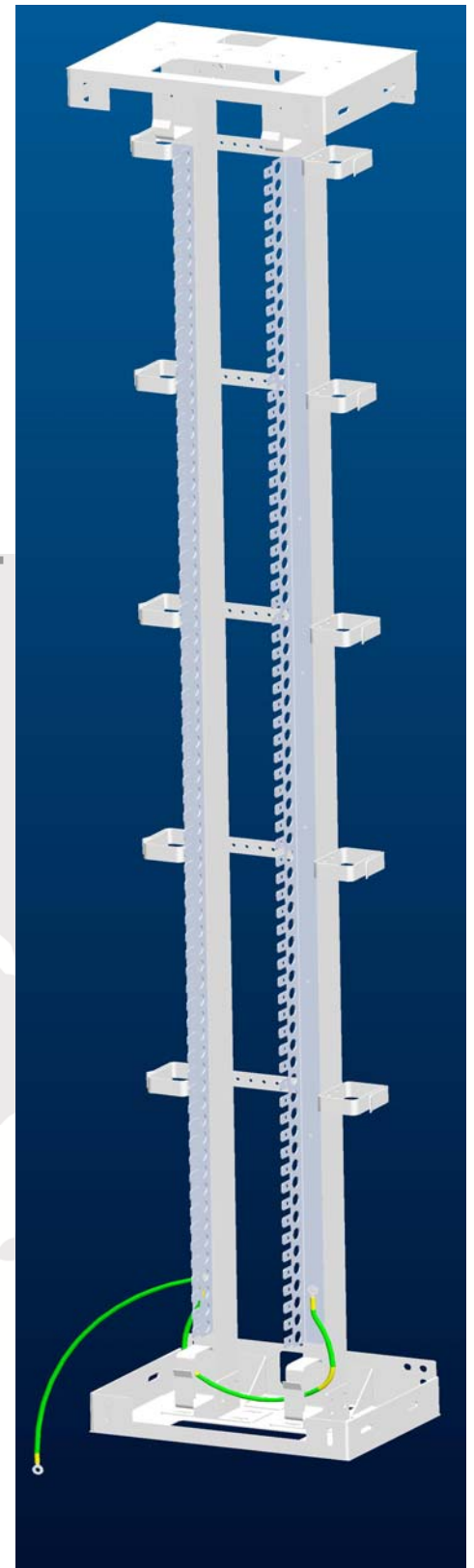

HONG KONG (HK) Limited

Unit 1303, 13/F, Beverly House, 93 -107 Lockhart Road, Wanchai, Hong Kong.
 香港灣仔駱克道93107-號利臨大廈13樓1303室

Tel. : (852) 28639635 Fax : (852) 21296534 Mob. : (86) 18218762001

EGYPT

15 Sakalia St., From Makram Abeed, 3rd Floor, Nasr City, Cairo, Egypt.

Tel. : +202 2671 8862 / 3 Fax : +202 2275 2976 Mob. : +2012 2213 3810